

QLF-480-30

DC~0.48GHz, 30dB

Features:

- * High Stopband Rejection
- * Small Size

Applications:

- * Telecom
- * Laboratory Test
- * Receivers
- * Instrumentation

Electrical

| | |
|------------------------|---------------------|
| Frequency: | DC~0.48GHz |
| Insertion Loss: | 3dB max. |
| Passband Flatness: | 3dB max. |
| VSWR: | 1.5 max. |
| Stop Band Attenuation: | 30dB@0.53~3GHz min. |

Mechanical

| | |
|----------------------|----------------------------------|
| Size ^{*1} : | 35*12*8mm 1.378*0.472*0.315in |
| RF Connectors: | SMA Female |
| Mounting: | 4-M2 depth 5mm |

[1] Exclude connectors

Environmental

| | |
|----------------------------|-----------|
| Operating Temperature: | -40~+70°C |
| Non-operating Temperature: | -55~+85°C |

Outline Drawings

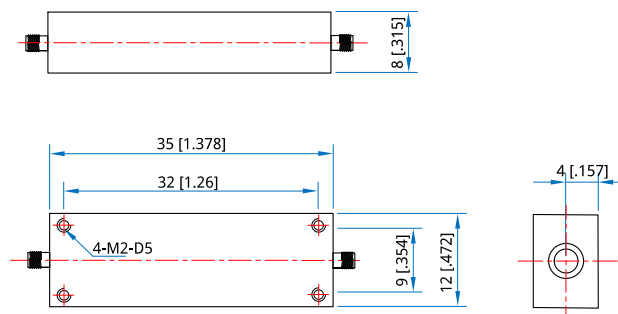

Unit: mm [in]

Tolerance: $\pm 0.5\text{mm}$ [$\pm 0.02\text{in}$]

How To Order

QLF-480-30

Customization is available upon request.